



Main Features

- For corrosive gasses and liquids
- Class 1.6 according to EN 837-1
- Wetted parts Stainless steel (MEX)
- Lloyd's Register approval
- Option : liquid-filled for applications with pulsations or vibrations
- Option : case material 1.4404 (316L) for aggressive atmosphere

Applications

- Food & Beverage
- Laboratory & Medical
- Oil & Gas / Chemical
- Water & Waste water
- Energy
- Transportation & Logistics
- Machinery

Technical Data

Nominal size	MEX3: 63 mm	Bezel ring	Stainless steel 1.4301 (AISI 304)
Measurement range	MEX3 : 0 ... 30 to 0 ... 3000psi	Movement	Stainless steel
Pressure limitation	Steady : 75% of full scale value Fluctuating : 65% of full scale value Short time : 100% of full scale value	Window	Polycarbonate
Accuracy	Class 1.6 (according EN837-1)	Window gasket	Elastomer
Protection rating	IP 65 (EN 60529)	Dial	Aluminium, white
Process Connection	MEX : Stainless steel 1.4404 (AISI 316L)	Pointer	Plastic, black
Bourdon tube	MEX : Stainless steel 1.4404 (AISI 316L)	Temperature	Ambient : -20 ... +70°C Medium : -40 ... +200°C (not filled) For liquid filled version see ordering details. The case temperature must not exceed +70°C Storage : -40 ... +70°C
Case	Stainless steel 1.4301 (AISI 304) Option : stainless steel 1.4404 (AISI 316L)	Thermal drift	± 0.4% F.S. / 10 K (reference : 20°C)
		Safety	S1 according EN837-1 (with window polycarbonate or laminated safety glass)

Options

Window laminated safety glass	Code 0751	To be ordered separately	
Restrictor screw Ø 0.3	Code 0769	Material certificate 3.1 EN10204	Code Q1229
Lloyd's Register approval	Code 0827	Calibration certificate EN837-1	Code Q1070
Accuracy class 1 (1.6 bar < P < 1000 bar)	Code 0841	(5 points raising and 5 points falling)	

Dimensions - Types of mounting

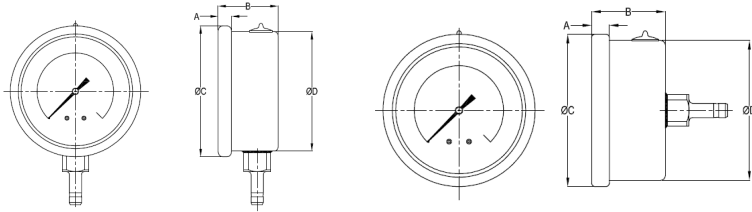

NS	A	B	ØC	ØD	Process Connection
63	6.5	30.5	68.5	62.5	Tube OD 1/4"

NS	A	B	ØC	ØD	Process Connection
63	6.5	30.5	68.5	62.5	Tube OD 1/4"

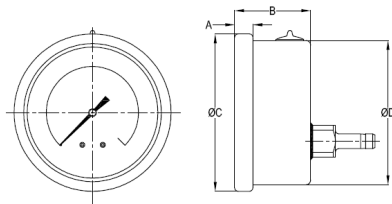

NS	A	B	ØC	ØD	Process Connection
63	6.5	30.5	68.5	62.5	Tube OD 1/4"

Pressure ranges

Code	psi			Code	Bar		
H17	0	...	30	B18	0	...	2.5
H19	0	...	60	B19	0	...	4
H21	0	...	100	B20	0	...	6
H22	0	...	160	B22	0	...	10
H23	0	...	200	B24	0	...	16
H25	0	...	300	B26	0	...	25
H26	0	...	400	B27	0	...	40
H27	0	...	600	B29	0	...	60
H30	0	...	1 000	B31	0	...	100
H31	0	...	1 500	B33	0	...	160
H34	0	...	3 000	B35	0	...	250

Ordering details - MEX2 - MEX3 - MEM3

		-			.	xxx	/	
Model	MEX							
All stainless steel pressure gauge								
Nominal size	3							
63 mm								
Type of mounting								
Stainless steel case and bezel ring 1.4301 (AISI 304)								
Bottom connection, back flange							A	
Back connection, front flange, 3 mounting holes							B	
Bottom connection							D	
Back connection							F	
Back connection with clamp							G	
Lower back connection, front flange							H	
Lower Back connection							I	
Process connection	X							
1/4 OD Tube stub (C050)								
Liquid filling								
Dry							0	
BH1 : low viscosity glycerin/water 86% (medium : -20 ... +70°C)							1	
BH2 : high viscosity glycerin 99.5% (medium : 0 ... +90°C)							2	
BH3 : silicone oil (medium : -40 ... +100°C)							3	
Unit of measurement / Pressure ranges ⁽³⁾								
bar							Bxx	
psi							Hxx	
kPa							Dxx	
kg/cm ²							Fxx	
bar / psi (double scale)							Kxx	
psi / kPa (double scale)							Vxx	
kPa / psi (double scale)							Wxx	
Options to be added behind the / (see example below)								
								(▶ Standard version)

Ordering example with options

